

**30 MINUTES FIRE RESISTANT WOODEN DOOR / SINGLE LEAF
USER MANUAL & ASSEMBLY INSTRUCTIONS**

EI30



30 Minutes
Fire & Smoke
Sealing

Indoor Life

KAPI BİLEŞENLERİ



1 Active Door Leaf



2-3 Side Frame Pieces



4 Head Frame Piece



5-7-9/6-8-10 Inner & Outer Architraves



Frame Assembling
Screw (4pcs)

NOT: 10 * 4mm fire and smoke seal and acoustic seal mounted on side frames and head frame.

The locations of the lock, hinges, drop-down seal and handle are not ready on the leaf. It will be done by monitor on site.

HARDWARE & ACCESSORIES



18 Hinge



13 Mortise Lock



Euro-cylinder



17 Drop-down Seal



19 Eye Viewer



16 Link-arm
Door Closer



16-A On-surface
Door Closer



15 Electronic Card
Access Handle

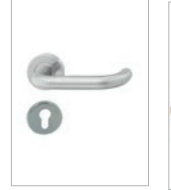

15-A Lever
Handle



20 10*4mm Fire
& Smoke Seal



21 Acoustic
Seal

Fire Door: Building element that is used in order to prevent / delay the spread of the fire that emerges in a certain part of the building while it is in the closed position, and it is used as an escape route when opened, providing integrity and insulation for a certain period during the fire.

Door Frame: Supporting frame that provides support for a door, surrounds the top and sides of the door, on which the door leaf is hung with hinges.

Door Architrave: Building element that gives a smooth view to the door by surrounding the outside of the door in both directions to ensure that the gaps between the door frame and the wall are closed.

Door Leaf: Movable panel that fills the space in the middle of the door frame and connects to the door frame with a hinge.

Intumescent Seal: Firestop material that expands and closes the gaps between the leaf and the frame, preventing the passage of flame and smoke for a certain period of time due to the increase in temperature exposed during the fire. Usually used between frame and leaf.

Door Lock: Security mechanism that allows the door to remain in a closed position and to be locked for security purposes when necessary, works with the help of a key and door handle.

Door Handle: Handle made of metal that provides the movement of the door during the closing and opening of the door.

Drop-down Seal: Aluminum profile inflated wick that closes the space under the door and prevents the passage of smoke, fire and sound when the door is in closed position,

Sub-Hardware Seal: Intumescent seal used under metal hardware to prevent heat transfer between different building materials.

Fire & Smoke Seal: Firestop material that swells by exposure to heat or smoke during the fire and closes the door gaps, thus helping the door to provide thermal insulation and integrity.

Fire Sealant: Chemical sealant that is resistant to fire for a certain period of time and is used for filling the outer-facing gaps in the conjunction of the door frame and the wall during the installation of the fire door, and serves to serve as a fire zone of the wall and the fire door.

Installation Foam Cap: Space left between the frame and the wall during the installation of the fire door.

Indoor Life F30 EI130 EI230 – Single Leaf / On-Surface Door Closer

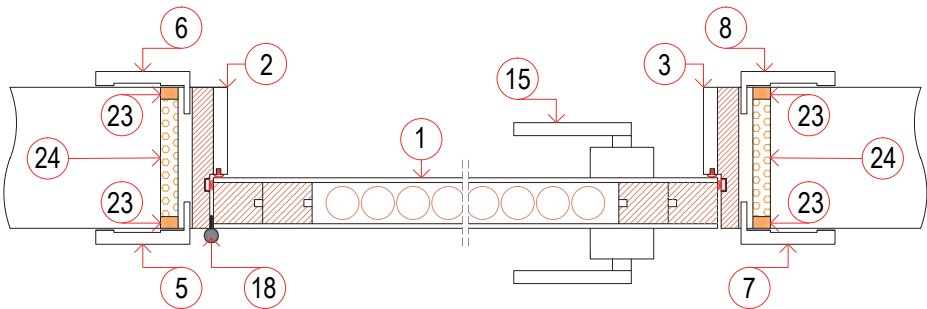
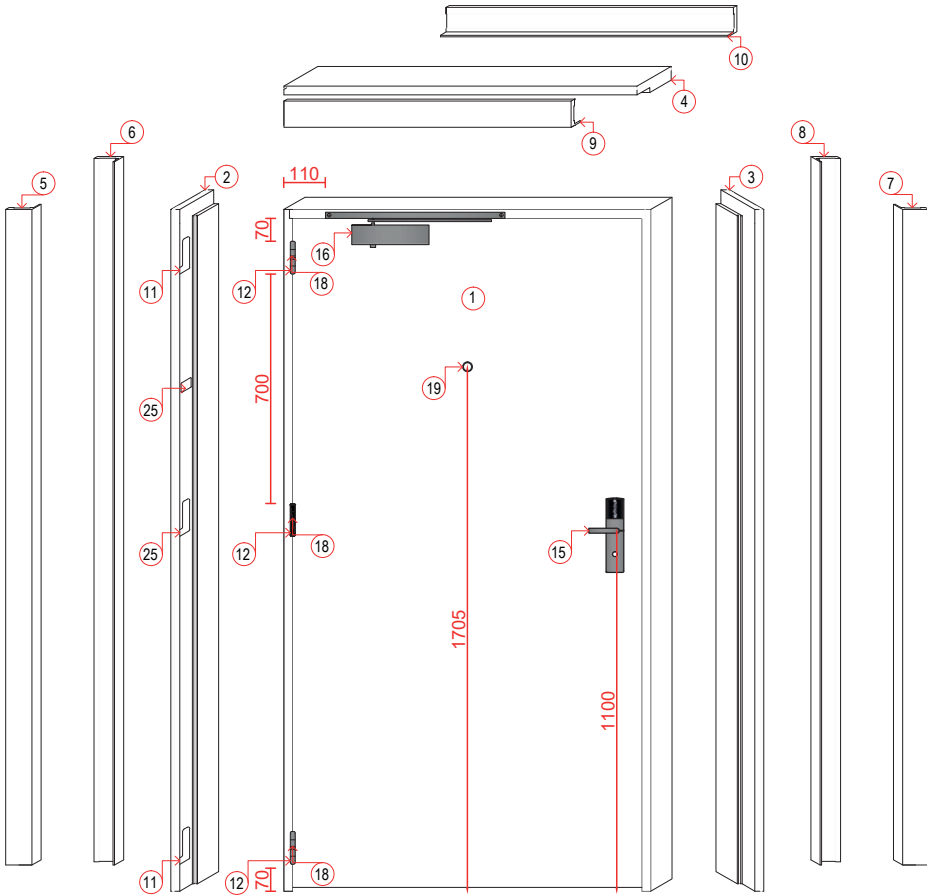

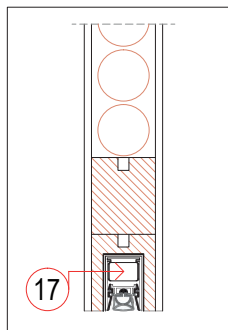
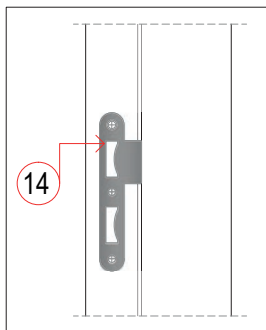
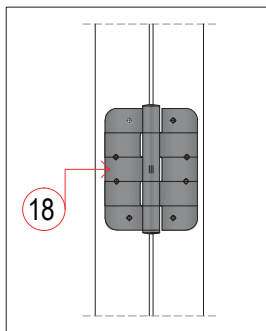
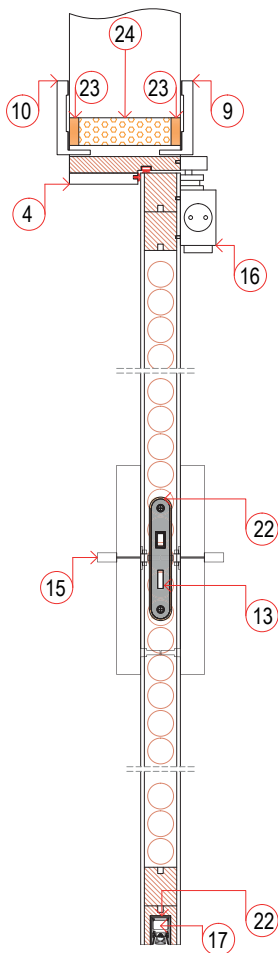

43mm Frame Seals

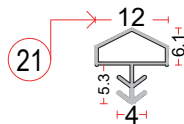
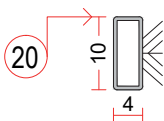

- 1 – Door Leaf
- 2 – Right Side Frame
- 3 – Left Side Frame
- 4 – Head Frame
- 5/7/9 – Inner Architraves
- 6-8-10 – Outer Architraves
- 11 – Place for Hinges (x3) on the frame
- 12 – Place for Hinges (x3) on the leaf
- 13 – Door Lock
- 14 – Door Lock Strike Plate

- 15 – Door Handle / Electronic Door Handle
- 16 – On-surface Door Closer
- 17 – Fire Resistant Drop-down Seal
- 18 – Butt Hinge 3 pcs
- 19 – Eye Viewer
- 20 – Fire & Smoke Seal 10*4mm on the frame
- 21 – Acoustic Seal on the Frame
- 22 – Sub-hardware Seal
- 23 – Fire Sealant
- 24 – Fire Resistant Foam
- 25 – Label

ASSEMBLY INSTRUCTIONS & TECHNICAL DRAWINGS

A) Assembling Frame



- Head frame and side frames are screwed together with 5x70 chipboard screws.
- Side frames are joined to the head frame by two screws on each side

B) Applying Cap for Foam



- After the head frame and side frames are assembled in U form, the frame is placed in the wall opening.
- 6 wedges are clamped on the upper side of the head frame (between the wall and the case).
- Frame alignment is done. It is controlled with a water gauge.

C) Hinge Installation Stages



Figure 1

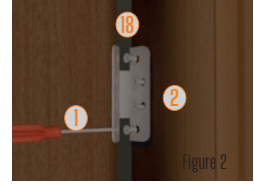

Figure 2

Figure 1 : Sub-hardware seal is placed on the hinge places on the frame and leaf.

Figure 2 : 3 hinges are screwed to the door leaf first.

Figure 2 : With the help of two people, the door leaf to which the hinge is screwed is brought closer to the hinge places on the framed and screwed, and so the leaf is mounted on the frame.

D) Fitting the Leaf and Tension Rod



Figure - 1



Figure - 2

Figure - 1 : Door fitting is done by performing the opening-closing movement.

Figure - 2 : A tension rod is placed between the side frames.

E) Applying Fire Resistant Foam



- Assembly foam is applied to the gap between the case and the wall, with no gap left, and it is left to dry.
- Drying time is 2 hours in summer and 3 hours in winter depending on weather conditions.
- After the foam has dried, the overflowing parts are trimmed with a utility knife.

F) Applying Fire Sealant and Installing Architrave

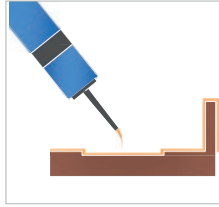

- After the architraves are cut according to the frame size, silicone is applied to the back of the architrave.

- The architraves are attached to the frame so that the nose of the architraves enters into the groove.

-Outer architraves (6/8/10) are also installed with the same method.

COMPLETING THE ASSEMBLY

Indoor Life F30 EI.30 EI.30 – Single Leaf / On-surface Door Closer



Details

- Production dimensions: 910*2080*150mm.
- Clear opening dimensions: 826*2038*150mm.
- Door leaf can be opened in both directions.
- 43mm leaf thickness
- 42mm frame
- 31 dB acoustic insulation
- On-surface door closer or link-arm door closer
- Elektronik door handle & normal door handle
- Fire resistant drop-down seal
- Can be applied up to 2.80 square meter.
- Fire & smoke seal

30 Mins. FIRE RESISTANT WOODEN DOOR TECHNICAL SPECIFICATIONS

Leaf: Wood veneer on 6mm MDF on both sides. Core material consists of 30 minutes fire resistant tubular particleboard. 35 * 42 mm solid fir wood filling. 43mm leaf thickness.

Frame: 18mm fir wood and 12mm MDF on both sides. 42mm frame thickness.

Architrave: 80*12mm – Flat. Consists of MDF. Acrylic sealant applied between frame and architrave.

Filling: Polyurethane based fire retardant expanding foam applied between wall and frame.

Sealant: Water-based acrylic sealant applied between frame and architrave.

Hinges: 3 pieces of – 14*102*77mm – Fire-resistant, HAFELE brand, stainless steel, ball-bearing hinges used on single leaf door. For hinge connecting dimensions, see page

On-surface Door Closer: Fire resistant, HAFELE brand, on-surface door closer.

Drop-down Seal: Fire resistant, PLANET brand, 13*10*85mm drop-down seal.

Lock: Fire resistant, HAFELE brand, stainless steel, mortise lock.

Euro-Cylinder: KALE 164GNC brand, 68mm euro-cylinder

Door Handle: Fire resistant, HAFELE-DT210FH brand, Card Access Door Handle. For handle center dimension, see page 3

Eye Viewer: Fire resistant, HAFELE brand eye viewer.

TERMS OF GUARANTEE

The warranty terms applicable to this product are subject to the terms and conditions published by our representative in the relevant country. You can get information about the subject from the seller where you bought the product. Please keep your sales receipt for the warranty claims.

MAINTENANCE OF FIRE RESISTANT WOODEN DOOR

The door should be checked to see if the hinge, door handle, door lock, drop-down seal, door closer and similar accessories are working by the technical inspector. In case of any malfunction of the accessories on the door, the administrative affairs manager or administrator should be informed. Especially on doors with fire and smoke sealing properties, accessories such as door seals and drop-down seal should be regularly maintained and these accessories should be checked to see if they are working properly. Care should be taken to clean the doors at least once a month.

Indoor Life®

Indoor Life®

İCM Uluslararası İnşaat Danışmanlık Pazarlama Sanayi ve Dış Ticaret A.Ş.

Head Office

Göztepe mahallesi
Güzel sokak,
Heper Apt. No: 2/5
Selamiçeşme Kadıköy / İstanbul
T: +90 216 302 43 00

Factory Showroom

İ.T.O.S.B 2.
Cadde No:7
Tuzla / İstanbul
T: +90 216 427 34 60

Çiftelievler Showroom

Cemil Topuzlu Caddesi
No: 30/A
Çiftelievler
Kadıköy / İstanbul
T: +90 216 386 11 57

indoorlife@indoorlife.com.tr | www.indoorlife.com.tr

  / indoorlifeatsapkapi